



RUSSELL SIMPSON

A four bedroom short let house on
one of Chelsea's most sought-after
squares

WELLINGTON SQUARE
CHELSEA SW3

Wellington Square

£4,500 _{P/W}

BEDROOMS 4	INTERNAL 2,703 _{SQ FT} 251 _{SQM}	OUTDOOR 829 _{SQ FT}	FURNISHED STATUS Furnished
BATHROOMS 3		EPC D	COUNCIL TAX RBKC, H



The Property

Five storey townhouse with passenger lift and roof terrace, located on a beautiful and historic garden square.

Indoor Spaces



Entering on the ground floor, the front hall opens onto a dining room with views over the garden square. In addition, a connecting corridor kitchen leads through to the terrace at the back of the house. Upstairs, an impressive reception room occupies the entire first-floor, with exceptionally high ceilings and a front-facing balcony running the width of the building.

The interior has two unusual features: a glass passenger lift running throughout the property, and air conditioning in a number of rooms. It is also finished to the highest quality in a dramatic monochrome colour scheme and available unfurnished.



The Bedrooms

On the second floor, the principal bedroom includes a generous ensuite, while two bedrooms with a shared bathroom complete the third floor. Finally, downstairs, the lower ground floor provides a bedroom, a bathroom, a study and considerable storage space.





Outdoor Spaces

The house is Grade II listed with a white stucco facade and was built around 1830. It contains a garden with wooden decking and a roof terrace with views over Chelsea. In addition, it is located on the eastern side of Wellington Square, a private garden with a formal design, shaded by mature plane trees.





The Neighbourhood

The square was laid out in the early nineteenth century and named after Arthur Wellesley, first Duke of Wellington. It was once home to A.A. Milne, author of Winnie-the-Pooh, as well as the fictional address of Ian Fleming's spy James Bond. Today, it is among the most desirable addresses in Chelsea, close to the excellent restaurants, shops and transport facilities of the Kings Road and Sloane Square, but with a sense of privacy and seclusion.

Wellington Square, SW3

**RUSSELL
SIMPSON**

Approx gross internal area

2703 sq ft / 251.11 sq m
(including under 1.5m area)

Vault & store room on roof terrace area

213 sq ft / 19.79 sq m
(including under 1.5m area)

Total Approx gross internal area

2915 sq ft / 270.90 sq m

Approx outdoor area

830 sq ft / 77.14 sq m

This plan is for layout guidance only. Not drawn to scale unless stated. Windows and door openings are approximate. Whilst every care is taken in the preparation of this plan, please check all dimensions, shapes, and compass bearings before making any decisions reliant upon them.

Key :
CH - Ceiling Height
X - Under 1.5m

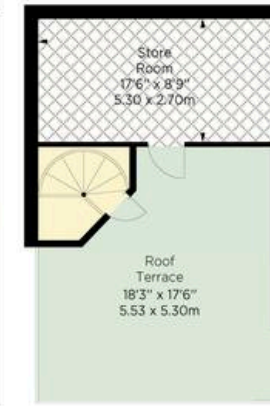
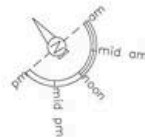

**ALEX
WINSHIP**
Photography Ltd.

"We warrant the guidance only, not to be used as a substitute for professional advice. It is not intended to be used as a substitute for professional advice. It is not intended to be used as a substitute for professional advice."

**Certified
Property
Measurement**

**RUSSELL
SIMPSON**

Contact Us

+44 (0) 20 7225 0277

151A Sydney Street
London
SW3 6NT

chelsea@russellsimpson.co.uk

In accordance with the Property Mis-Description Act 1991, the following details have been prepared in good faith, and are not intended to constitute part of an offer or contract. Any information contained herein (whether in the text, plans or photographs) is given in good faith but should not be relied upon as being a statement of representation of fact. Nothing in these Particulars shall be deemed to be a statement that the property is in good condition or otherwise nor that any services or facilities are in good working order. Any measurements of distances referred to herein are approximate only. October 2021