

RUSSELL SIMPSON

One bedroom flat to rent moments
away Kensington High Street station

KENSINGTON HIGH STREET
KENSINGTON W8

Kensington High Street

Let

BEDROOMS 1	INTERNAL 538 _{SQ FT}	OUTDOOR —	FURNISHED STATUS Furnished
BATHROOMS 1	49 _{SQM}	EPC B	COUNCIL TAX RBKC, B



The Property

Exceptionally convenient flat with minimalist interiors and beautiful views over a mews street.

Entering the flat on the first floor, the front halls leads through to a generous reception room. This includes an open-plan kitchen, as well as enough space for separate dining and eating areas. In addition, this room has high ceilings and tall windows giving extra light throughout the day.

img 1

Reception Room

img 2

Kitchen





Indoor Spaces

The rear side of the flat features a double bedroom with built-in storage. The bedroom faces south, with a pair of windows looking down the picturesque street of Adam and Eve Mews.

The property also includes a bathroom with bath. It has wooden floors, underfloor heating and is finished in a contemporary fashion.





The Neighbourhood

The flat is located in the heart of Kensington. The restaurants, shops and underground station of High Street Kensington are all within easy reach. In addition, the southern entrance to Holland Park is a short walk away.

Kensington High Street, W8

**RUSSELL
SIMPSON**

Approximate Internal Area
538 sq ft/ 50 sq m

This plan is for layout guidance only. Not drawn to scale unless stated. Windows and door openings are approximate. Whilst every care is taken in the preparation of this plan, please check all dimensions, shapes, and compass bearings before making any decisions reliant upon them.

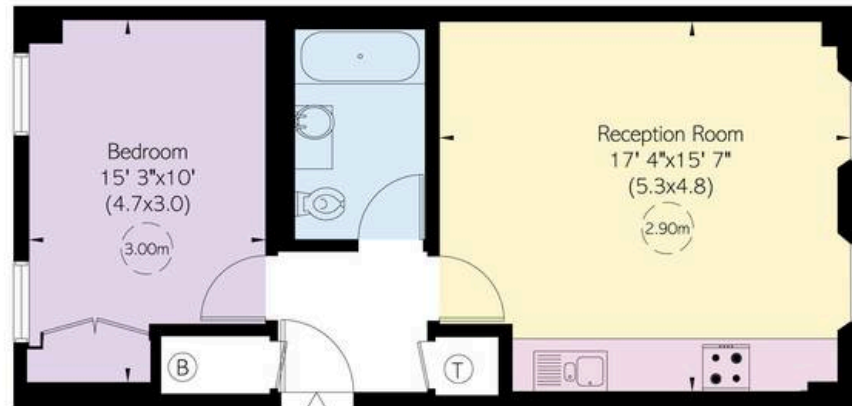
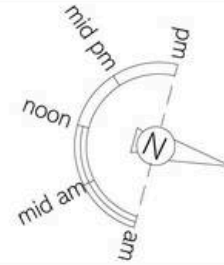

First Floor

**RUSSELL
SIMPSON**

Contact Us

+44 (0) 20 7225 0277

Contact us

info@russellsimpson.co.uk

Sydney Street

+44 (0) 20 7225 0277

151A Sydney Street

London

SW3 6NT

chelsea@russellsimpson.co.uk

Kensington Square

+44 (0) 20 3761 9691

13 Kensington Square

London

W8 5HD

kensington@russellsimpson.co.uk