



RUSSELL SIMPSON

Tasteful two-bedroom flat to rent on
a prestigious street close to Green
Park station

HILL STREET
MAYFAIR W1J

Hill Street

£1,260 P/W

BEDROOMS 2	INTERNAL 732 <small>SQ FT</small>	OUTDOOR —	FURNISHED STATUS Multiple Options
BATHROOMS 2	68 <small>SQM</small>	EPC D	COUNCIL TAX Westminster City, G

The Property

Conveniently located flat in a popular apartment building within easy reach of Hyde Park

Stepping into the flat on the first floor, the front hall leads into a well-proportioned reception room. This includes an open-plan kitchen, as well as separate dining and seating areas.





Indoor Spaces

The flat is decorated in a restrained classical fashion and presented in very good condition.





The Bedrooms

The flat also features two bedrooms. The principal bedroom has an ensuite bathroom and inbuilt wardrobe space. The second bedroom has a bathroom next door.



The Neighbourhood

This popular Art Deco building offers both porter and lift.

Hill Street is a historic address in the heart of Mayfair. It features the neighbourhood's oldest public house, as well as numerous listed buildings. It has also inspired settings in the novels of Jane Austen, Sir Walter Scott, William Makepeace Thackeray and Evelyn Waugh.

From here, the charming, village-like streets of Shepherd Market are close. The first-class restaurants and shops of Piccadilly and New Bond Street are also nearby. Finally, Green Park underground station is a short walk away, along with the open spaces of the Green Park and Hyde Park.

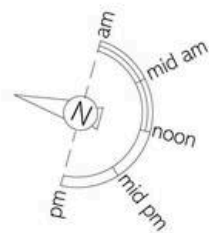

Hill Street, W1

Approximate Internal Area
735 sq ft/ 68 sq m

**RUSSELL
SIMPSON**

This plan is for layout guidance only. Not drawn to scale unless stated. Windows and door openings are approximate. Whilst every care is taken in the preparation of this plan, please check all dimensions, shapes, and compass bearings before making any decisions reliant upon them.

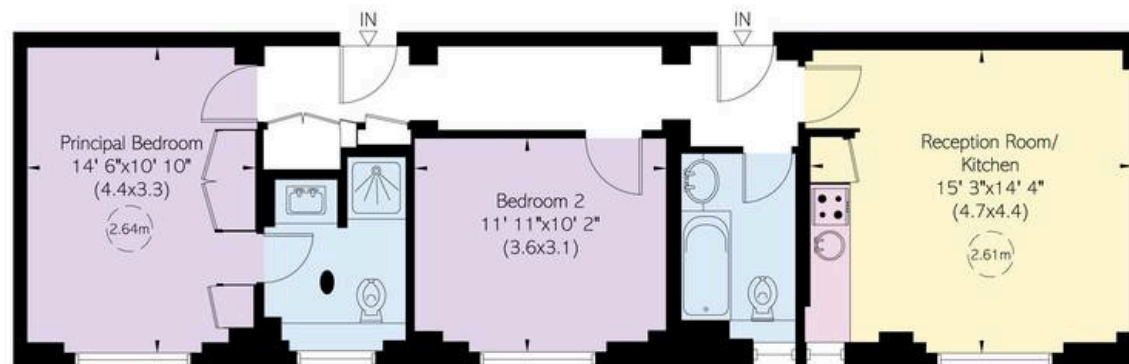

First Floor

**RUSSELL
SIMPSON**

Contact Us

+44 (0) 20 3761 9691

13 Kensington Square
London
W8 5HD

kensington@russellsimpson.co.uk