



RUSSELL SIMPSON

Stylish four-bedroom house by a
celebrated Modernist architect

SOUTHERN ROW
NORTH KENSINGTON W10

Southern Row

£3,200,000

BEDROOMS 4	INTERNAL 2,514 SQ FT	OUTDOOR 14 SQ FT	COUNCIL TAX RBKC, E
BATHROOMS 3	233 SQM	EPC C	TENURE Freehold



The Property

Beautifully designed and decorated house with light-filled interiors close to Golborne Road

Indoor Spaces



Stepping into the house on the ground floor, the entrance hall opens onto a self-contained downstairs suite. This includes a study, a bedroom, an ensuite bathroom and storage space. This level also features a utility room and a guest WC.

The first floor is entirely occupied by a generous living area. As well as separate dining and seating spaces, there is an open-plan kitchen with modern units. South and east facing windows create a double aspect, while a skylight above the kitchen ensures this room is filled with light throughout the day. Furthermore, wooden floors and a French door opening onto a balcony add to the sense of brightness and space.



The Bedrooms

The second floor consists of two bedrooms sharing a bathroom. Meanwhile, the third floor is entirely occupied by the principal bedroom suite, which includes a generous dressing room and an ensuite bathroom. Rounded windows flood the space with light and offer attractive views.



The Design

The house contains a spectacular staircase running up one side of the building. This not only allows for wider rooms, but also maximises the light in the living spaces. It is decorated in a tasteful contemporary style and presented in good condition.

The house was designed by Julian Wickham, one of the most influential British architects of the post-war period. He was responsible for the Fifth Floor Restaurant at Harvey Nicholls, as well as the iconic Kensington Place. Wickham is celebrated for blending a bold minimalism with a playful sense of urban style. The property has since been occupied by a photography collector and gallerist, who has added to the creative elegance of the interiors.

[Watch an interview with the owner here.](#)





The Neighbourhood

The house is a few moments' walk away from Golborne Road, with its trendy collection of restaurants, shops and cafes. In addition, Westbourne Park and Ladbrooke Grove underground stations are both within easy reach. Furthermore, the Grand Union Canal is close, with its attractive towpath for running and walking. Finally, North Kensington is well supplied with schools.

Southern Row, W10

**RUSSELL
SIMPSON**

Approximate Internal Area
2,514 sq ft/ 234 sq m

Outside Area
15 sq ft/ 1 sq m

This plan is for layout guidance only. Not drawn to scale unless stated. Windows and door openings are approximate. Whilst every care is taken in the preparation of this plan, please check all dimensions, shapes, and compass bearings before making any decisions reliant upon them.



Ground Floor

First Floor

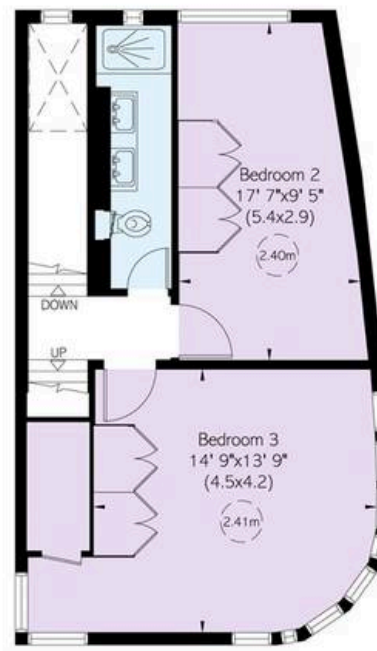

Second Floor



Third Floor

**RUSSELL
SIMPSON**

Contact Us

+44 (0) 20 3761 9691

13 Kensington Square
London
W8 5HD

kensington@russellsimpson.co.uk