

## **RUSSELL SIMPSON**

Beautiful one-bedroom flat close to  
the King's Road and Sloane Square

SMITH STREET  
CHELSEA SW3

Smith Street

£895,000

BEDROOMS 1	INTERNAL 527 SQ FT	OUTDOOR —	COUNCIL RBKC
BATHROOMS 1	48 SQM	EPC C	COUNCIL TAX E
TENURE Share of freehold	LEASE LENGTH 976 YEARS	GROUND RENT —	SERVICE CHARGE £2,577 P/Y



## The Property

Charmingly decorated flat on a quiet and attractive street in the heart of Chelsea

# Indoor Spaces

Entering the flat on the second floor, the front hall leads into a reception room on one side, with enough space for separate dining and seating areas and sash windows as well as an ornamental fireplace giving this room a sense of style. Opposite, the convenient kitchen has fitted units and roof top views



img 1

Kitchen

img 2

Dining Space



## The Bedroom

The flat also contains a double bedroom with inbuilt wardrobes and a bathroom with a bath. Its interiors are decorated in a colourful fashion, adding to the character and charm. They are presented in good condition.



---

img 1

Bathroom

---

img 2

Bedroom



## The Neighbourhood

Smith Street is an attractive address in the heart of Chelsea. It is lined by Victorian terrace houses with white stucco bases. The restaurants and shops of the King's Road are close, while Sloane Square underground station is within walking distance. The exceptional sports facilities of Burton Court are also nearby, and residents have the right to apply for membership.

# Smith Street, SW<sub>3</sub>

**RUSSELL  
SIMPSON**

**Approximate Internal Area**  
527 sq ft/ 49 sq m

This plan is for layout guidance only. Not drawn to scale unless stated. Windows and door openings are approximate. Whilst every care is taken in the preparation of this plan, please check all dimensions, shapes, and compass bearings before making any decisions reliant upon them.

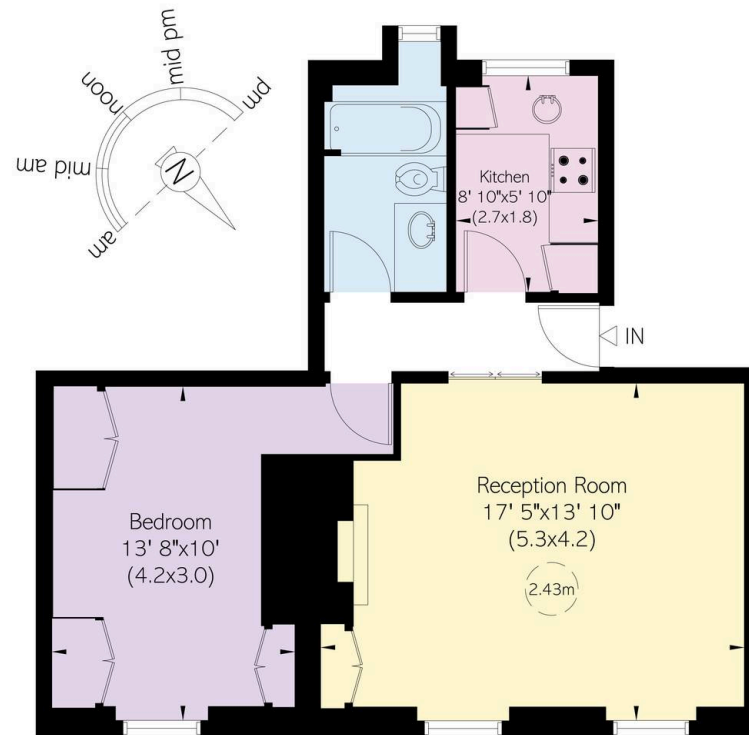

Second Floor

**RUSSELL  
SIMPSON**

---

## Contact Us

+44 (0) 20 7225 0277

Contact us

[info@russellsimpson.co.uk](mailto:info@russellsimpson.co.uk)

---

## Sydney Street

+44 (0) 20 7225 0277

151A Sydney Street

London

SW3 6NT

[chelsea@russellsimpson.co.uk](mailto:chelsea@russellsimpson.co.uk)

---

## Kensington Square

+44 (0) 20 3761 9691

13 Kensington Square

London

W8 5HD

[kensington@russellsimpson.co.uk](mailto:kensington@russellsimpson.co.uk)