



RUSSELL SIMPSON

A graceful two-bedroom flat
moments away from the Fulham
Road

HOLLYWOOD COURT
CHELSEA SW10

Hollywood Court

£1,175,000

<div>BEDROOMS</div> <div>2</div>	<div>INTERNAL</div> <div>879 <small>SQ FT</small></div> <div>81 <small>SQM</small></div>	<div>OUTDOOR</div> <div>—</div>	<div>COUNCIL</div> <div>RBKC</div>
<div>BATHROOMS</div> <div>2</div>		<div>EPC</div> <div>C</div>	<div>COUNCIL TAX</div> <div>F</div>
<div>TENURE</div> <div>Share of freehold</div>	<div>LEASE LENGTH</div> <div>995 <small>YEARS</small></div>	<div>GROUND RENT</div> <div>—</div>	<div>SERVICE CHARGE</div> <div>£3,690 <small>P/Y</small></div>

The Property

A third-floor flat with an elegant finish, in a Victorian mansion block on the popular Hollywood Road.





Indoor Spaces

The flat is centred around a large and beautiful reception room, with windows facing north and west. Its walls and doors are decorated with panel moulding, adding to the sense of refinement. As well as a seating area around the ornate fireplace, there is also space enough for a separate dining area. The reception room opens onto the kitchen, as well as a separate storage cupboard.





The Bedrooms

The principal bedroom has a window bay looking out over Hollywood Road, while the second bedroom has a wide bank of windows looking out over the same aspect. Both bedrooms include inbuilt storage, the white wardrobes matching the picture rails and decorative cornices. A pair of tastefully decorated bathrooms complete the property.





The Neighbourhood

Hollywood Road is a delightful street, mixing apartment buildings, terrace houses with Doric porches, and a mix of restaurants, pubs and bakeries. Part of the Boltons Conservation Area, most of its properties were built in the early 1860s – before the more famous Hollywood, in California, was settled. Its south-east end joins the Fulham Road, with a full range of shops and transports link. Fulham Broadway underground station is a short walk away, as well as the beautiful parkland and Victorian tombs of the Brompton Cemetery.

HOLLYWOOD COURT, HOLLYWOOD ROAD, SW10

Approximate Area = 879 sq ft / 81.7 sq m (Excluding Reduced Headroom)

Reduced Headroom = 2 sq ft / 0.2 sq m

Total = 881 sq ft / 81.9 sq m

Including Limited Use Area (1.7 sq m / 18 sq ft)

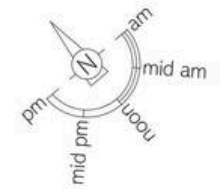

[] = Reduced head height below 1.5m

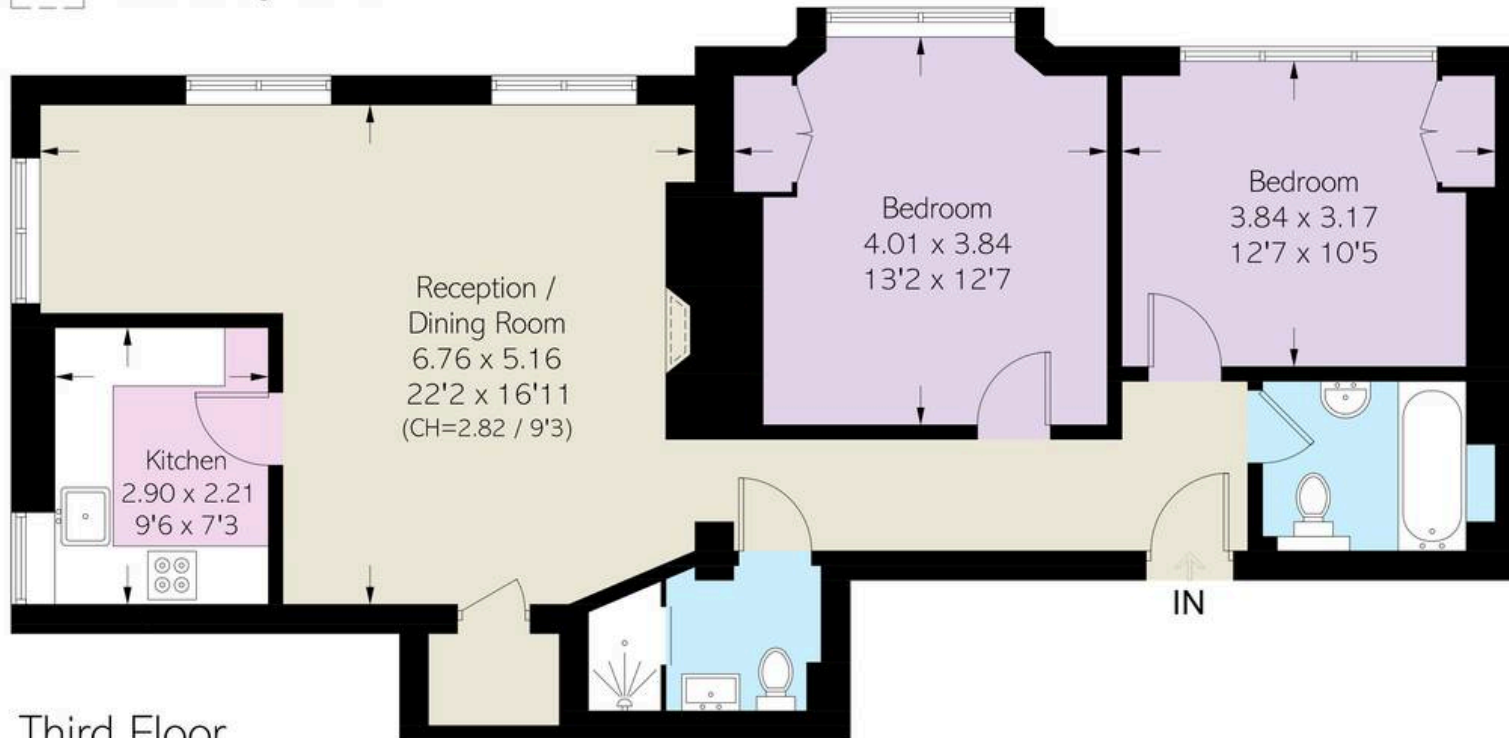

Third Floor

VIEWING ARRANGEMENTS

Telephone: +44 (0) 20 7225 0277
Email: info@russellsimpson.co.uk

This plan is for layout guidance only. Not drawn to scale unless stated. Windows and door openings are approximate. Whilst every care is taken in the preparation of this plan, please check all dimensions, shapes and compass bearings before making any decisions reliant upon them.

RUSSELL SIMPSON

**RUSSELL
SIMPSON**

Contact Us

+44 (0) 20 7225 0277

151A Sydney Street
London
SW3 6NT

chelsea@russellsimpson.co.uk

In accordance with the Property Mis-Description Act 1991, the following details have been prepared in good faith, and are not intended to constitute part of an offer or contract. Any information contained herein (whether in the text, plans or photographs) is given in good faith but should not be relied upon as being a statement of representation of fact. Nothing in these Particulars shall be deemed to be a statement that the property is in good condition or otherwise nor that any services or facilities are in good working order. Any measurements of distances referred to herein are approximate only. October 2021