



RUSSELL SIMPSON

An exquisite two-bedroom property
with open and green aspects.

ERESBY HOUSE
KNIGHTSBRIDGE SW7

Eresby House

Sold

BEDROOMS 2	INTERNAL 882 SQ FT	OUTDOOR 48 SQ FT	COUNCIL —
BATHROOMS 2	81 SQM	EPC D	COUNCIL TAX G
TENURE Share of freehold	LEASE LENGTH 960 YEARS	GROUND RENT £200 P/Y	SERVICE CHARGE £12,600 P/Y



The Property

This immaculate and well-proportioned flat offers a bright and open outlook over the communal gardens of Rutland Gate. Sitting on the second floor (with a lift), the flat has a lovely entrance, leading through to a bright and spacious living room with a balcony. There are also two large double bedrooms, with two bathrooms. It holds a preferable corner position in the building giving it bright and green views from each window.





The Neighbourhood

Eresby House is a prestigious 1930's Art Deco building situated moments from Hyde Park and the heart of Knightsbridge. This highly sought-after building offers acclaimed 24-hour porterage, first come, first served parking and a quietly leafy location moments from the hustle and bustle of London's most highly regarded amenities.

Eresby House, SW7

APPROX. GROSS INTERNAL AREA *
882 Sq Ft - 81.94 Sq M

This floorplan is for GUIDANCE ONLY and NOT FOR VALUATION purposes.

Key :
CH - Ceiling Height

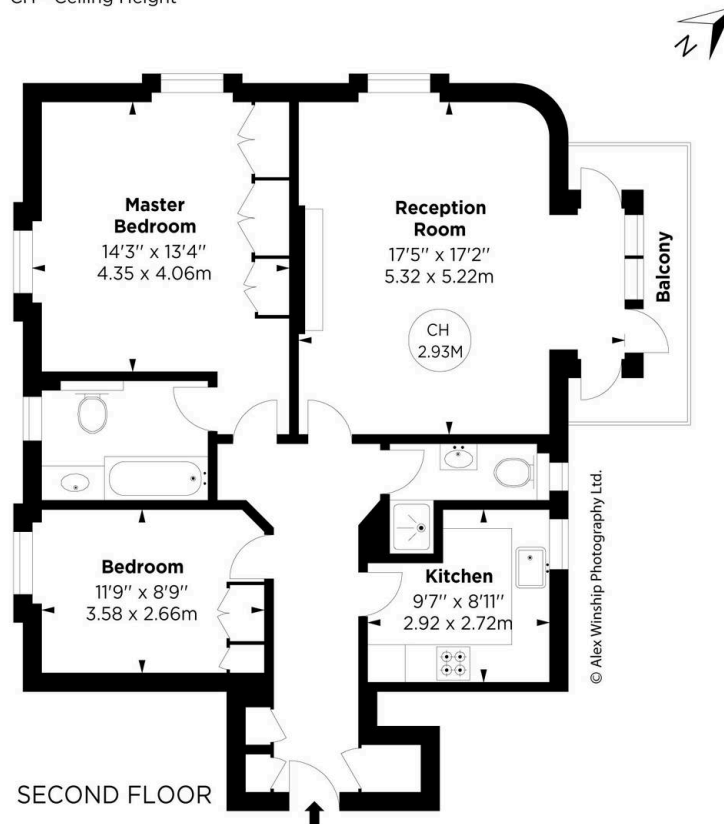

ALEX WINSHIP
Photography
© Alex Winship Photography Ltd.

*Floorplan for guidance only, not to scale or valuations purposes. It must not be relied upon as a statement of fact. All measurements and areas are approximate and have been prepared in accordance with the current edition of the RICS Code of Measuring Practice.



**RUSSELL
SIMPSON**

Contact Us

+44 (0) 20 7225 0277

Contact us

info@russellsimpson.co.uk

Sydney Street

+44 (0) 20 7225 0277

151A Sydney Street

London

SW3 6NT

chelsea@russellsimpson.co.uk

Kensington Square

+44 (0) 20 3761 9691

13 Kensington Square

London

W8 5HD

kensington@russellsimpson.co.uk